

**Drain:** HIGHLAND SPRINGS DRAIN      **Drain #:** 165  
**Improvement/Arm:** HIGHLAND SPRINGS - SECTION 4-5  
**Operator:** JDH      **Date:** 6-22-04  
**Drain Classification:** Urban/Rural      **Year Installed:** 1982

### GIS Drain Input Checklist

- Pull Source Documents for Scanning JDH
- Digitize & Attribute Tile Drains N/A
- Digitize & Attribute Storm Drains JDH
- Digitize & Attribute SSD JDH
- Digitize & Attribute Open Ditch JDH
- Stamp Plans JDH
- Sum drain lengths & Validate JDH
- Enter Improvements into Posse JDH
- Enter Drain Age into Posse JDH
- Sum drain length for Watershed in Posse JDH
- Check Database entries for errors JDH

**Gasb 34 Footages for Historical Cost  
Drain Length Log**

Drain-Improvement: HIGHLAND SPRINGS DRAIN-HIGHLAND SPRINGS-SECTION 2-5

Drain Type:	Size:	Length <small>SURVEY REPORT</small>	Length (DB Query)	Length Reconcile	If Applicable	
					Price:	Cost:
SSD	6"	1,770'	1,770'	✓	\$2.00	\$3,540.00
SSD	8"	2,763'	2,763'	✓	3.00	8,289.00
CMP	12"	734'	734'	✓	14.00	10,276.00
(TWIN)CMP	30"	56'	56'	✓	55.00	3,080.00
RCP	12"	482'	482'	✓	7.25	3,494.50
SWALE		1,100'	1,100'	✓	19.55	21,505.00 *

Sum:          6,905'    6,905'                \$50,184.50

Final Report: \_\_\_\_\_

Comments:

\* PRICED AS OPEN DITCH

\_\_\_\_\_  
 \_\_\_\_\_  
 \_\_\_\_\_  
 \_\_\_\_\_  
 \_\_\_\_\_



SURVEYOR'S OFFICE

# Hamilton County

Kenton C. Ward, Surveyor

773-6110 Ext. 19

Noblesville, Ind. 46060 December 29, 1982

TO: Hamilton County Drainage Board

RE: Highland Springs

Attached is an assessment roll, drain map, drainage shed map and petition, dated December 6, 1982, for a drain for Highland Springs. This drain was originally petitioned on July 1, 1980. However, because it was incomplete and not constructed per plan, I would not accept the petition. The Developers Engineer has now certified that the drainage system has been completed. This certification is on the attached sepia of the drain map.

This drainage system for Sections 1,2,3,4 and 5 consists fo the following.

Between Lots 22 & 23

2-30" CMP's	56' ✓
Swale	200' ✓

Between Lots 8 & 9 & Intersection

2-Catch Basins with inlets	
12" Pipe	166' ✓
Swale to pond	120' ✓
12" Metal End Section	

Between Lots 33 & 34 & Intersection

12" metal end section	
12" Pipe	316' ✓
4-Catch Basins with inlets	
Swale	100' ✓
Subsurface Drains	
6" Plastic tile	1770'
8" Plastic tile	2670'
also includes some swales	

Between Lots 98 & 99

Catch Basin with inlet	
12" Pipe	124' ✓
12" Metal end section	
Swale	200' ✓

Between Lots 61 & 62 and 44 & 45

Swale	200' ✓
12" Pipe	290' ✓
2-12" Metal end sections	
2-Catch Basins with inlets	

Between Lots 48 & 49

12" Pipe	140' ✓
12" Metal End Section	
2-Catch Basins with inlets	
Swale	150' ✓

Between Lots 53 & 54 and intersection

12" Pipe	180' ✓
Swale	130' ✓
12" Metal End Section	
3-Catch Basins with inlets	

The total length for this drain is 6,812 feet, with 89 Lots assessed (5.0a) at \$20.00 each and \$2.00 per acre for streets, the Total yearly assessment will be \$ 1790.00 .

Upon review of the petition I find that it is in order. Also after personal inspection of the site and review of the material I believe that the proposed drain is 1.) Practicable; 2.) will improve the public health, benefit a public highway, be of public utility; and 3.) The costs, damages and expenses of the proposed improvement will probably be less than the benefit which will result to owners of lands likely to be benefited.

I also believe it should be classified as an Urban Drain.

I recommend that a hearing be set to include the drainage system as a regulated drain and place it on a maintenance program. This hearing should be held on March 7, 1983 at 1:40pm.

I also recommend that Mr. Carter's cash bond for 150% of the estimated cost of completion dated June 8th 1982, be held until the regulated drain is certified to the Auditor.

KCW/no

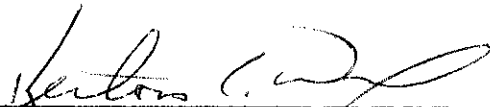
  
Kenton C. Ward-County Surveyor

June 10, 2003

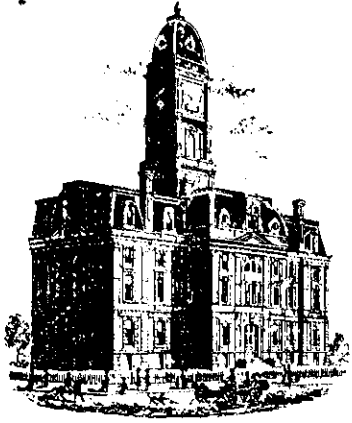

# SURVEYOR'S OFFICE Hamilton County

Kenton C. Ward, Surveyor  
Phone (317) 776-8495  
Fax (317) 776-9628

Suite 188  
One Hamilton County Square  
Noblesville, Indiana 46060-2230

## Map Correction-Field Verification

**Drain Number:** Highland Springs

**Drain Length:** 6812

**Drain Name:** #165

**Change +/- :** +93

**Date:** June 10, 2003

**New Length:** 6905

**Verified By:** Suzanne Mills & Stephen Baitz (WO-2000-00084)

### Notes & Sketch:

There was an additional 106 feet of 8" ssd found across the rear of lot 61. The 8" ssd across lot 62 was not run to the curb as originally mapped. The drain is tapped into the 12" cmp that runs paralell to it. That resulted in a loss of 13 feet of 8" ssd. Thus - the total length of drain to be added was 93 feet. The work order above saw the instillation of a riser on the 8" ssd running across lot 62. When the field check was recently performed we took measurements for risers that had been previously added at an earlier time. There is a map attached showing our field check numbers.

Suzanne L. Mills  
GIS Specialist

WD-2000-00084 - FIELD CHECK

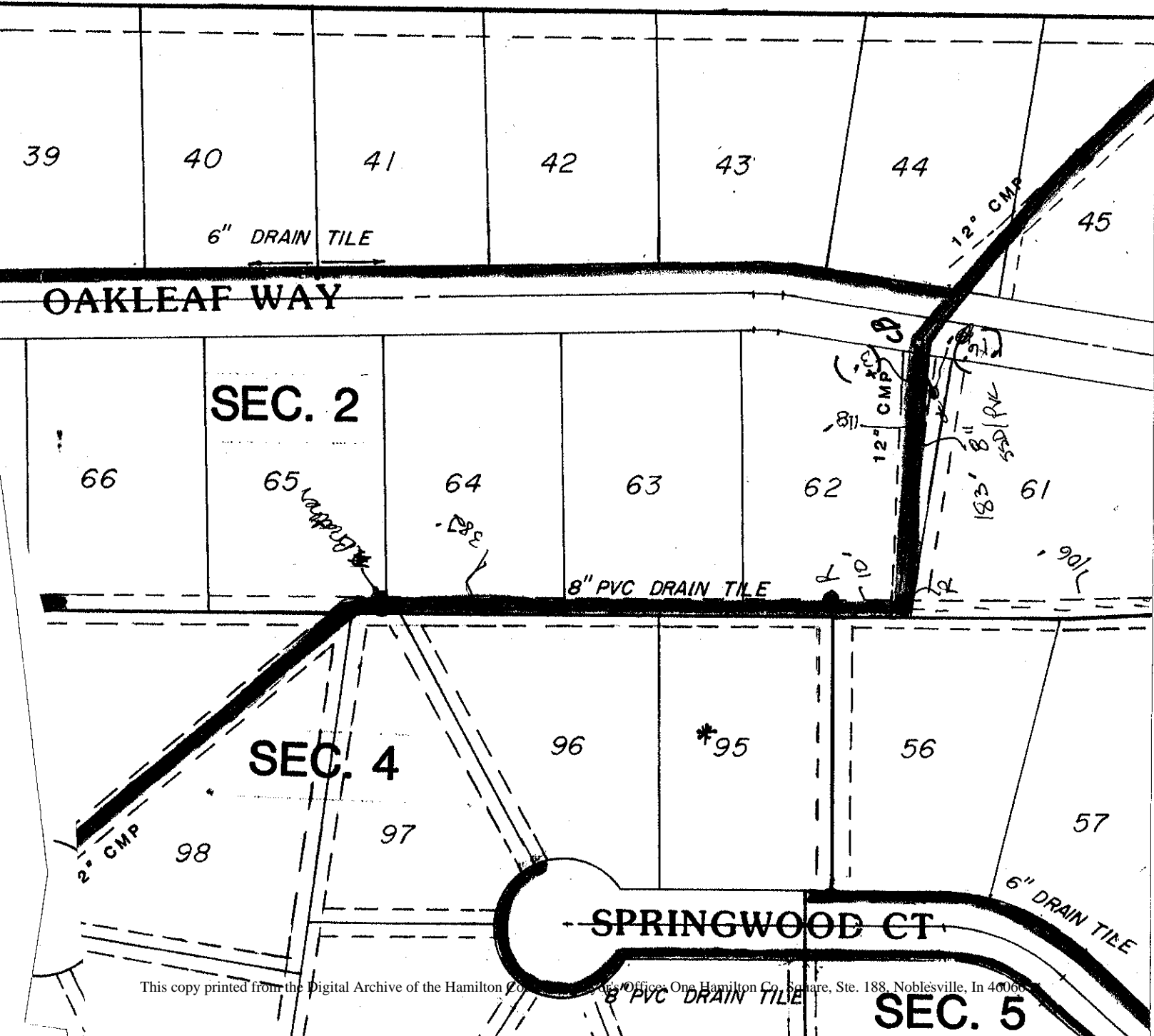

SEC. 5